

# POLY-NORM® Flexible coupling

## Selection of standard IEC motors

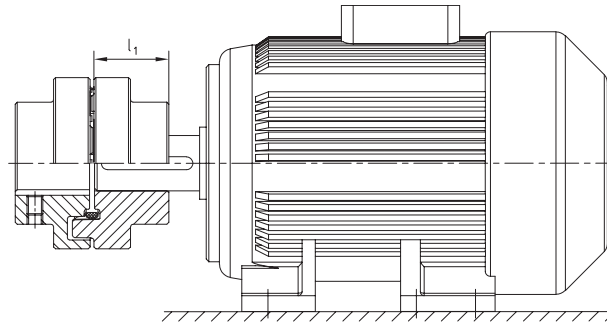

POLY-NORM® couplings for standard IEC motors, protection class IP 54/IP 55 (elastomer ring 78 Shore A)														
A. C. motor 50 Hz			Motor power n= 3000 rpm 2 poles		POLY-NORM® coupling size	Motor power n= 1500 rpm 4 poles		POLY-NORM® coupling size	Motor power n= 1000 rpm 6 poles		POLY-NORM® coupling size	Motor power n= 750 rpm 8 poles		POLY-NORM® coupling size
Size	Shaft end dcl [mm]		Power P [kW]	Torque T [Nm]		Power P [kW]	Torque T [Nm]		Power P [kW]	Torque T [Nm]		Power P [kW]	Torque T [Nm]	
	2 poles	4, 6, 8 poles												
56	9 x 20		0.09	0.32		0.06	0.43		0.037	0.43				
			0.12	0.41		0.09	0.64		0.045	0.52				
63	11 x 23		0.18	0.62		0.12	0.88		0.06	0.7				
			0.25	0.86		0.18	1.3		0.09	1.1				
71	14 x 30		0.37	1.3		0.25	1.8		0.18	2		0.09	1.4	
			0.55	1.9		0.37	2.5		0.25	2.8		0.12	1.8	
80	19 x 40		0.75	2.5	28/32	0.55	3.7	28/32	0.37	3.9	28/32	0.18	2.5	28/32
			1.1	3.7		0.75	5.1		0.55	5.8		0.25	3.5	
90S	24 x 50		1.5	5		1.1	7.5		0.75	8		0.37	5.3	
90L			2.2	7.4		1.5	10		1.1	12		0.55	7.9	
100L	28 x 60		3	9.8		2.2	15		1.5	15		0.75	11	
						3	20					1.1	16	
112M			4	13		4	27		2.2	22		1.5	21	
132S			5.5	18		5.5	36		3	30		2.2	30	
132M	38 x 80		7.5	25	38	7.5	49	38	4	40	38	3	40	38
									5.5	55				
160M	42 x 110		11	36		11	72		7.5	75	42	4	54	42
			15	49	42			42				5.5	74	
160L			18.5	60		15	98		11	109		7.5	100	
180M	48 x 110		22	71	48	18.5	121	48			48			48
180L						22	144		15	148		11	145	
200L	55 x 110		30	97		30	196	55	18.5	181	55	15	198	55
			37	120	55				22	215				55
225S	55 x 110					37	240				60	18.5	244	60
225M	60 x 140		45	145		45	292	60	30	293		22	290	
250M	60 x 140		55	177	60	55	356	65	37	361	65	30	392	65
280S	65 x 140		75	241		75	484		45	438		37	483	
280M	75 x 140		90	289	65	90	581	75	55	535	75	45	587	75
315S			110	353		110	707		75	727		55	712	
315M	80 x 170		132	423		132	849	85	90	873	85	75	971	85
	65 x 140		160	513	75	160	1030		110	1070		90	1170	90
315L			200	641		200	1290	90	132	1280	90	110	1420	
					85				160	1550		132	1710	100
315	85 x 170		250	802		250	1600		200	1930	100	160	2070	100
			315	1010		315	2020	100	250	2410	110	200	2580	110
			355	1140	90	355	2280		315	3040	125	250	3220	125
355	75 x 140		400	1280		400	2570	110	400	3850		315	4060	
			500	1600		500	3210				140			
			560	1790	100	560	3580		450	4330		355	4570	140
400	80 x 170		630	2020		630	4030		500	4810		400	5150	
		110 x 210	710	2270	110	710	4540	140	560	5390	160	450	5790	160
			800	2560		800	5120		630	6060		500	6420	
450	90 x 170		900	2880	125	900	5760	160	710	6830		560	7190	180
		120 x 200	1000	3200		1000	6400		800	7690	180	630	8090	180

The coupling selection is based on an ambient temperature of up to +30 °C. The selection is based on a minimum safety factor of 2 to the max. coupling torque ( $T_{K \max}$ ). A detailed selection is possible according to catalogue page 15 et seqq. Drives with periodical torque curves must be selected according to DIN 740 part 2. If requested, KTR will perform the selection.

Torque T = rated torque according to Siemens catalogue M 11 · 1994/95.

# POLY-NORM® AR

## Flexible couplings

### Two-part

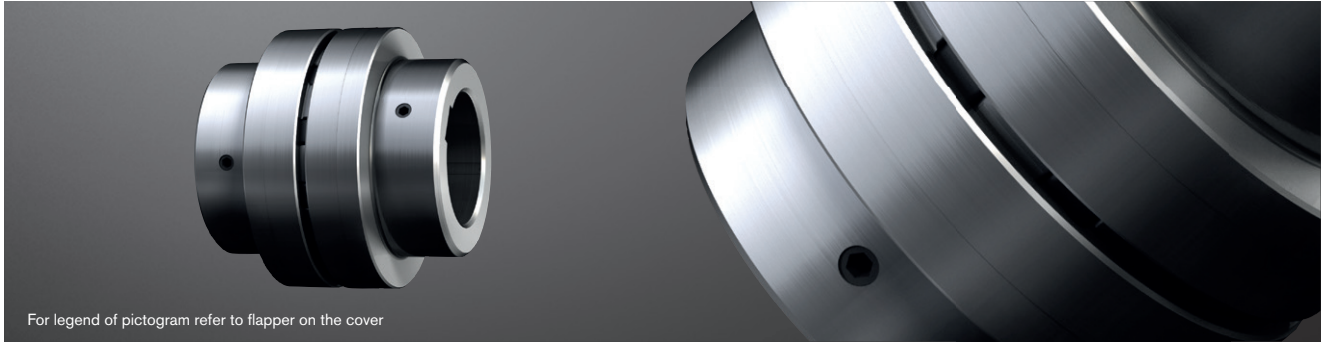

For legend of pictogram refer to flapper on the cover

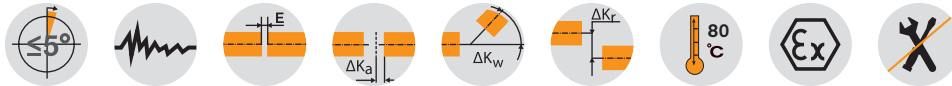

### Components

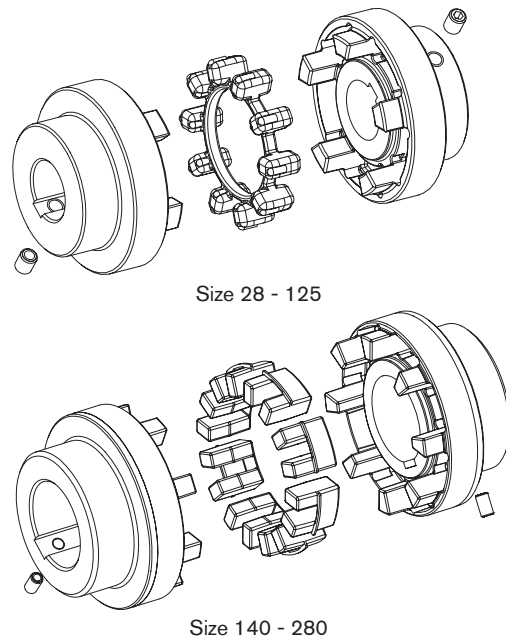
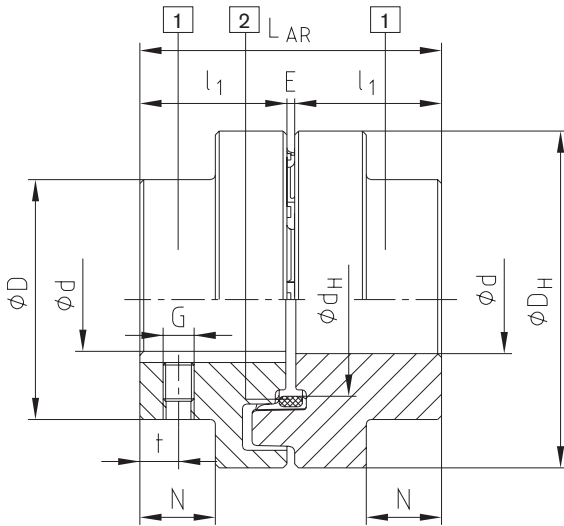

Components of type AR:  
 1 = Standard hub (GJL)  
 2 = Elastomer ring (up to size 180: NBR 78 ShA; from size 200: T-PUR® 84 ShA)

POLY-NORM® Type AR															
Size	Elastomer ring <sup>1)</sup>		Max. finish bore d <sup>2)</sup>	Dimensions [mm]										Mass moment of inertia <sup>3)</sup> [kgm <sup>2</sup> ]	Weight <sup>3)</sup> [kg]
	(component <sup>2)</sup> Torque [Nm]			General							Setscrew <sup>2)</sup>				
	T <sub>KN</sub>	T <sub>K max</sub>		L <sub>AR</sub>	l <sub>1</sub>	E	D <sub>H</sub>	D	d <sub>H</sub>	N	G	t			
28	40	80	12-30	59	28	3	69	46	36.5	12	M5	7	0.0004	0.9	
32	60	120	12-35	68	32	4	78	53	41.5	14	M8	7	0.0008	1.4	
38	90	180	19-40	80	38	4	87	62	50	19.5	M8	10	0.0016	2.0	
42	150	300	19-45	88	42	4	96	69	55.5	20	M8	10	0.0026	2.7	
48	220	440	19-50	101	48	5	106	78	64	24	M8	15	0.0042	3.7	
55	300	600	19-60	115	55	5	118	90	73	29	M8	14	0.0070	5.5	
60	410	820	19-65	125	60	5	129	97	81	33	M8	15	0.0112	6.9	
65	550	1100	19-70	135	65	5	140	105	86	36	M10	20	0.0174	8.8	
75	850	1700	32-80	155	75	5	158	123	100	42.5	M10	20	0.028	13.5	
85	1350	2700	32-90	175	85	5	182	139	116	48.5	M10	25	0.052	19.5	
90	2000	4000	32-95	185	90	5	200	148	128	49	M12	25	0.090	23.2	
100	2900	5800	42-110	206	100	6	224	165	143	55	M12	25	0.160	31.9	
110	3900	7800	50-120	226	110	6	250	185	158	60	M16	30	0.317	38.0	
125	5500	11000	55-140	256	125	6	280	210	178	70	M16	35	0.570	55.2	
140	7200	14400	65-155	286	140	6	315	235	216	76.5	M20	35	1.030	92.6	
160	10000	20000	75-175	326	160	6	350	265	246	94.5	M20	45	1.746	126.9	
180	13400	26800	75-200	366	180	6	400	300	290	111.5	M20	50	3.239	181.8	
200	19000	38000	85-200	408	200	8	450	335	-	126	M24	50	5.728	263.7	
220	30000	60000	95-220	448	220	8	500	370	-	140	M24	50	9.489	355.9	
240	43000	86000	105-240	488	240	8	550	405	-	154	M24	50	14.963	466.3	
260	55000	110000	115-260	530	260	10	650	440	-	158	M24	60	29.504	672.2	
280	67000	134000	125-280	570	280	10	700	475	-	172	M24	60	42.451	836.6	

<sup>1)</sup> Standard material Perbunan [NBR] 78 Shore A, size 140 - 280 double tooth elastomers, for selection see page 14 et seqq.

<sup>2)</sup> Bores H7 with keyway to DIN 6885 sheet 1 [JS9] and setscrew on the keyway

<sup>3)</sup> Referring to average bore

# POLY-NORM® AR Flexible couplings

## For taper clamping sleeve

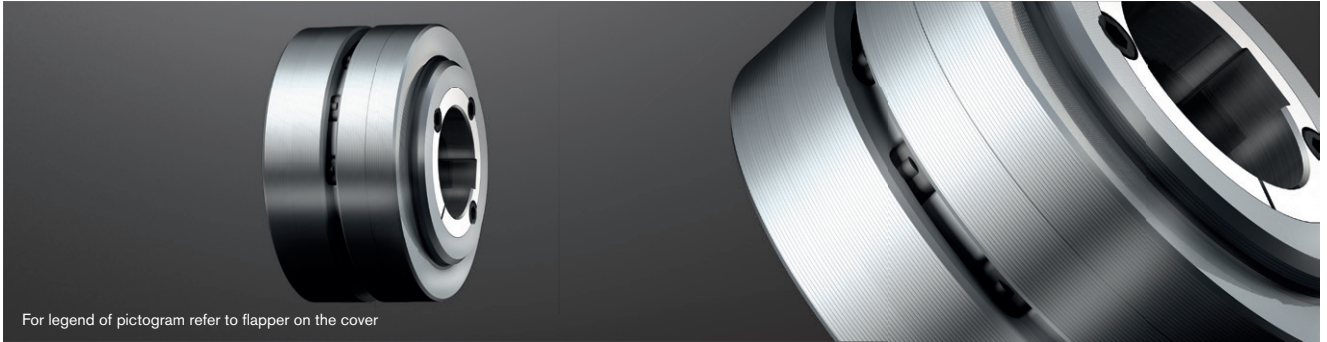

For legend of pictogram refer to flapper on the cover



### Components

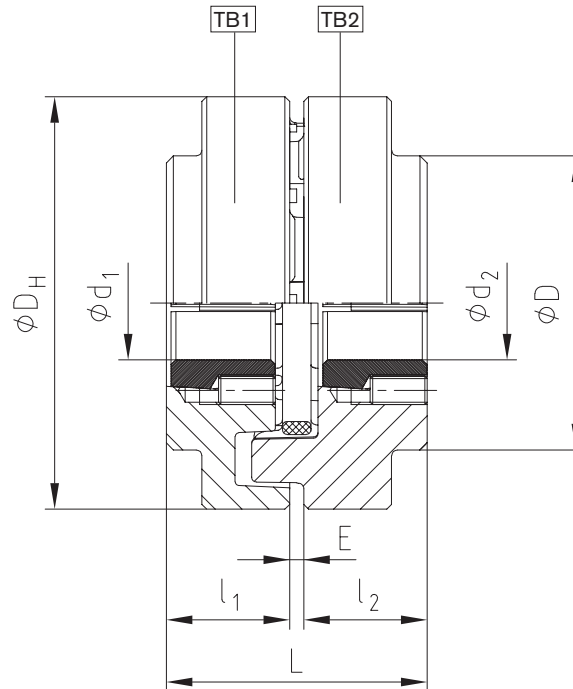

POLY-NORM® for taper clamping sleeve															
Size	Taper clamping sleeve	Dimensions [mm]		Fastening screws <sup>1)</sup> for taper clamping sleeve				Size	Taper clamping sleeve	Dimensions [mm]		Fastening screws <sup>1)</sup> for taper clamping sleeve			
		Max. $d_1, d_2$	$l_1, l_2$	Size [Inch]	Length [mm]	SW [mm]	TA [Nm]			Max. $d_1, d_2$	$l_1, l_2$	Size [Inch]	Length [mm]	SW [mm]	TA [Nm]
32	1108	25	25.5	1/4"	13	3	5.7	75	2517	60	52.5	1/2"	25	6	49
42	1210	32	31.0	3/8"	16	5	20	85	2517	60	46.5	1/2"	25	6	49
48	1610	40	30.0	3/16"	16	5	20			3030	75	82	5/8"	32	8
		1615	40	42.5	3/8"	16	5	20	3020	75	52.0	5/8"	32	8	92
60	2012	50	38.5	7/16"	22	6	31	100	3535	90	98.0	1/2"	38	10	115
65	2517	60	62.5	1/2"	25	6	49	125	4040	100	111.5	5/8"	45	12	172

<sup>1)</sup> Each 2 fastening screws, with 3535/4040 3-off

For coupling type TB1 screw connection on cam side - TB2 screw connection on collar side  
Combination possible! Please order our separate dimension sheet (M407045).

Ordering example:	POLY-NORM® 38	AR	Ø38	Ø30
	Coupling size	Type	Finish bore	Finish bore